

DEEPWATER AQUILA

ULTRA-DEEPWATER DUAL-ACTIVITY DRILLSHIP



Note: Transocean is expecting delivery of the Deepwater Aquila from its constructing shipyard in South Korea in Q4 of 2023.

For additional information please contact:

Transocean
Marketing Department
1414 Enclave Parkway
Houston, TX 77077, USA
Phone: + 1-713-232-7500
Fax: + 1-713-232-7880
marketing@deepwater.com
www.deepwater.com

General Description

Design / Generation	DSME Ultra Deepwater Drillship
Constructing Shipyard	DSME Shipyard, Korea
Year Entered Service / Significant Upgrades	2023
Classification	ABS, AMS, ACCU, CDS, DPS-3, DLA, OHCM, UWILD, CRC, HELIDK (SRF), WT-READY, NBLES, BWT, CPS
Flag	Marshall Islands
Dimensions	782.1 ft. (238.4 m) x 137.8 ft. (42 m) x 62.3 ft. (19 m) depth
Drafts	Operating 39.4 ft. (12 m) / Transit 29.5 ft. (9 m)
Accommodation	200 persons
Displacement	113,538 st. (103,000 mt) Operating
Variable Deck	26,455 st. (24,000 mt) operating / 19,841 st. (18,000 mt) transit
Transit Speed	12.5 knots
Maximum Water Depth	12,000 ft. (3,658 m) designed / ~10,000 ft. (3,048 m) outfitted
Maximum Drilling Depth	40,000 ft. (12,190 m)

Drilling Equipment

Derrick	Dual Dynamic Bottle Neck Type (DDBN-1400/1000). 209.97 ft. (64 m) clear lifting height x 78.74 ft (24 m) x 59.05 ft. (18 m). Designed to API-4F 4 th edition, SSL E2/U2
Gross Hook Loads	(Main) 1,400 st. (1,270 mt) capacity (Aux) 1,000 st. (907 mt) capacity
Drawworks	(Main) NOV non-compensated drawworks 1400 st-9000 hp (Aux) NOV non-compensated drawworks 1000 st-5750 hp
Compensator	(Main) NOV CMC-E-1500/2800-7x78 and (Aux) CMC-1000/2000-6x78, rated (main) 1,400 st. (1,270 mt) (aux) 1,000 st. (907 mt) static, (main) 750 st. (680 mt) (aux) 500 st. (454 mt) compensating, 25 ft (7.62 m) stroke
Rotary Table	(Main) NOV RST-755 75-1/2" hydraulic rated at 1,375 st. (1,250 mt), (Aux) NOV RST-605 60-1/2" hydraulically rated at 1,000 st. (907 mt) (aux); both 45,000 ft.-lbs. maximum continuous torque
Top Drive	NOV TDX-1250 1,250 st. (1,134 mt) (main), NOV TDX-1250 1,250 st. (1,134 mt) (aux) Maximum Speed 275 rpm, continuous torque 105,000 ft.-lbs at 130rpm
Tubular Handling	(Main) Hydratong MPT 270 (Aux) Hydratong ARN-270 Iron Roughnecks for tubulars ranging from 3-1/2" to 10"9-3/4". Racking systems for tubular range of 4-1/4" to 14" with two (2) vertical NOV/HR-IV-ER Hydraracker pipe racking systems. One (1) NOV Pipe Catwalk Shuttle, CWS-P15-45-HB. Maximum capacity 16.5 st. (15 mt), 50 ft. (15.2 m) all tubular including 30" casing diameter.
Riser Feed	One (1) NOV Riser Catwalk Machine, CWM-R55-90-HS Maximum capacity 60.6 st. (55 mt). (2) Riser gantry cranes 30mt.
Mud Pumps	Four (4) NOV 14-P-220 AC triplex pumps, 7,500 psi, each driven by two (2) x GE 1,150hp 57kW motors plus space for a fifth optional pump
HP Mud System	Rated 7,500 psi
Solids Control	Two (2) Brandt Triple VSM 300-MS triple deck shale shakers.

Cranes

Cranes	Three (3) 110 st. (100 mt) NOV knuckle boom cranes at 65 ft (20 m) radius, rated at 27 st. (25 mt) at a radius of 147. (45 m)
Subsea Crane	One (1) 181st (165mt) active heave compensated knuckle boom crane for handling subsea equipment to 12,007 ft. (3,660 m)

Power & Machinery

Main Power	6ea STX - MAN 16V32/40 4-stroke, 720 rpm, each driving a 7650 kW x 11kV generator
Emergency Power	One (1) 4-stroke, 1,800rpm STX-Cummins QSK60DMGE (MCRS) diesel engine rated at 1,700 kW driving a 690 VAC 1,700kW, 2125kVA generator.
Power Distribution	Three (3) ABB 11KV AC switchboards. Five (5) 690VAC Low Voltage (3 Aft, 1 Forward, 1 Topside) 3 Drilling VFD switchboards. 1 emergency 690VAC switchboard.

Storage Capacities

Fuel Oil	58,369 bbl. (9,280 m3)
Liquid Mud	(active + reserve + slug) 22,668 bbl. (3,604 m3)
Base Oil	8,434 bbl. (1,314 m3)
Brine	8,434 bbl. (1,314 m3)
Drill Water	22,272 bbl. (3,541 m3)
Potable Water	11,925 bbl. (1,896 m3)
Bulk Material	(mud + cement) 36,727 cu. ft. (1,040 m3)
Sack Storage	10,080 sacks

BOP & Subsea Equipment

BOP	One (1) x seven (7) ram 18-3/4" x 15,000 psi NOV BOP consisting of two (2) triples and one (1) single. Dual BOP capable.
LMRP	One (1) LMRP, including two (2) single 18-3/4" 10,000 psi WP annular.
BOP Handling	NOV BOP Moonpool Trolley rated at 716 st. (650mt). BOP Crane with two (2) x 330st (300mt) main hoist
Marine Riser	NOV FT-H 21" OD Flanged. With 4 1/2" ID K/C lines 15k and 4" ID booster line.
Tensioners	NOV 3,600 kips combined capacity using eight (8) NOV WRT-225-D50PL dual riser tensioners rated at 225 kips each, 50 ft. (15.24 m) Stroke
Diverter	NOV 21" x 500 psi with one (1) 18" Overboard Valve feeding a 18" Flow selector with two (2) 18" overboard line.
Tree Handling	One (1) 1,102 st. (1,000mt) Combined Xmas Tree Trolley and Xmas Tree skidding system. Tree crane (deck crane) with 182 st. (165mt) hoisting capacity. Four (4) 165 st. (150mt) skid cart
BOP Controls	NOV Multiplex control system, with deadman system, auto-shear, acoustic emergency back-up system and ROV Intervention.
Moonpool	114.83 ft. (35 m) length x 31.49 ft. (9.7 m) width opening at main deck

Station Keeping / Propulsion System

Thrusters	Six (6) Rolls Royce UUC 455 FPP variable speed, demountable azimuthing thrusters, 5,500 kw.
DP System	DP-3 rated for water depth up to 12,000 ft. (3,658 m) with backup DP system. Kongsberg SDP-23 / DP3 installation

Other Information

Helideck	Rated for Sikorsky S-61N and Sikorsky S-92 helicopters
----------	--

Revision Date: 17 October 2023



These specifications are intended for general reference purposes only, as actual equipment and specifications may vary based upon subsequent changes, the contract situation and customer needs. All equipment shall be operated and maintained at all times, in compliance with Transocean standard operating manuals, policies and procedures, and within its stated operational limits or continuous rated capacity, in order to assure maximum operational efficiency.

Patent Notice: This rig, its systems, components, and/or equipment in use on this rig, may be protected by one or more US and/or foreign patents. See <http://www.deepwater.com/patents> for details.

DEEPWATER AQUILA

ULTRA-DEEPWATER DUAL-ACTIVITY DRILLSHIP

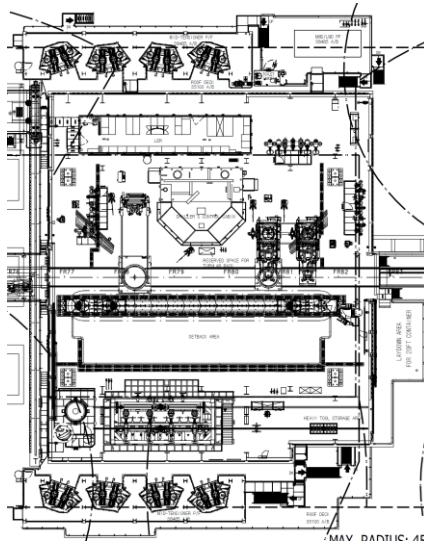
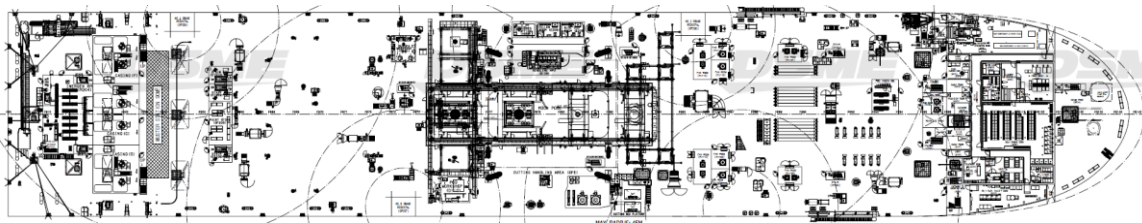
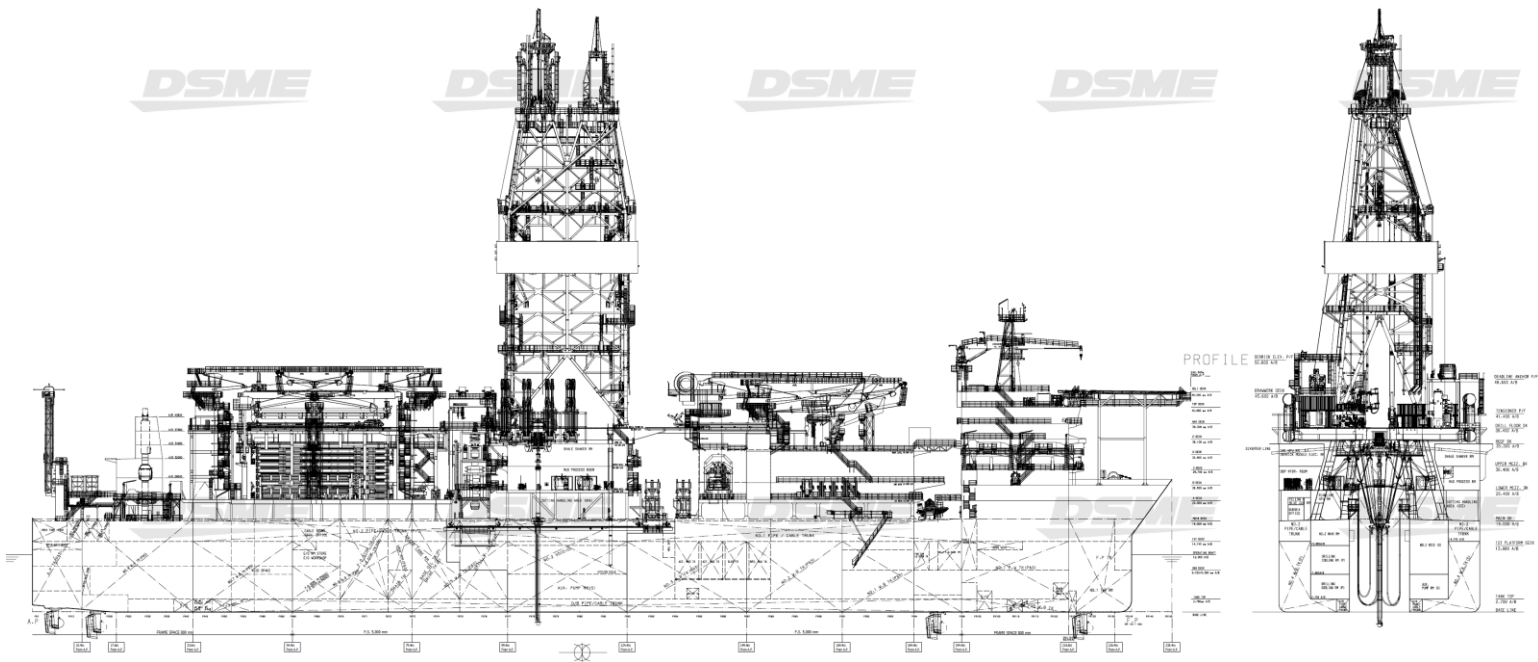

BOUNDLESS

Revision Date: 17 October 2023

SERVICE FOCUSED
DATA DRIVEN
PERFORMANCE ORIENTED



These specifications are intended for general reference purposes only, as actual equipment and specifications may vary based upon subsequent changes, the contract situation and customer needs. All equipment shall be operated and maintained at all times, in compliance with Transocean standard operating manuals, policies and procedures, and within its stated operational limits or continuous rated capacity, in order to assure maximum operational efficiency.

Patent Notice: This rig, its systems, components, and/or equipment in use on this rig, may be protected by one or more US and/or foreign patents. See <http://www.deepwater.com/patents> for details.